

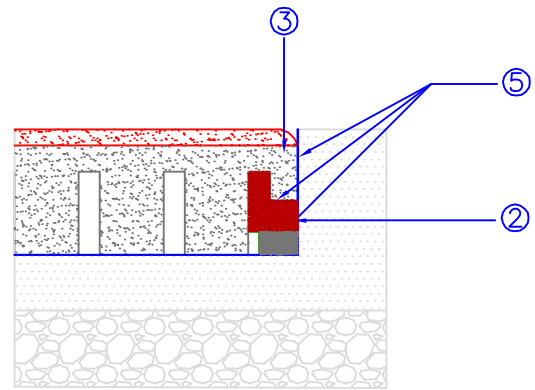

BY SofSURFACES Inc.
 P.O. BOX 239, 4393 DISCOVERY LINE
 PETROLIA, ONTARIO
 N0N 1R0
 PHONE: (800) 263-2363
 PHONE: (519) 882-8799
 FAX: (519) 882-2697
 EMAIL: alltinfo@sofsurfaces.com

INSTALLATION OF KrosLOCK® TILE AGAINST A VERTICAL SURFACE (CONCRETE CURB, WALL OR TIMBER)

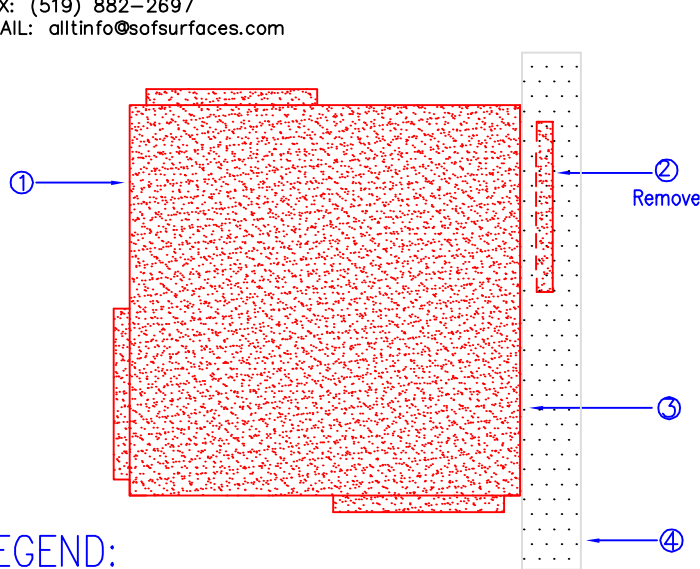

SECTION

Shows Outer Channel Inserted
 Underneath Inner Channel
 For Support.

LEGEND:

- ① SofTILE® (See Specifications for Thickness and Color).
- ② Outer Channel.
- ③ Inner Channel.
- ④ Vertical Surface (Curb, Wall or Timber) See Specifications for Details.
- ⑤ Applied Adhesive (See Installation Instructions Below).

INSTALLATION INSTRUCTIONS:

1. Cut Outer Channel ② Flush With Edge of Tile to Allow Installation Against Vertical Surface.
2. Rotate and Insert Outer Channel ② Underneath Adjacent Inner Channel ③.
3. 1/2" Diameter Continuous Bead of SofTILE Adhesive at Each KrosLOCK Joint.
4. Apply SofTILE Adhesive to Hold Outer Channel in Place. In addition, adhere the edge of the SofTILE surface to the surrounding retainer wall as well as the first 12" of the SofTILE surface (bottom) around the perimeter of the area.

THICKNESS	CRITICAL FALL HEIGHT (FT)		REVISIONS			
	WITH 10 YR PERFORMANCE WARRANTY PLUS	WITH 10 YR PERFORMANCE WARRANTY PREMIUM	REV	DESCRIPTION	DATE	APPR
	1.75"	3.0	3.0	0	ORIGINAL ISSUE	12/17/03
2.00"	4.0	4.0	1	ADJUSTED ADHESIVE APPLICATION	10/20/04	
2.25"	5.0	5.0	2	REVISED	02/02/06	
2.50"	6.0	6.0				
2.75"	7.0	7.0				
3.25"	8.0	8.0				
3.50"	9.0	9.0				
3.75"	10.0	10.0				
FILE NAME A0001SK5 PREPARED BY B.GOSS			SIZE A	FSCM NO.	DWG NO. 1SK5	REV 1
			SCALE	NTS	SHEET	